

DC LINK CAPACITOR REPLACEMENT ELECTROLYTIC CAPACITOR

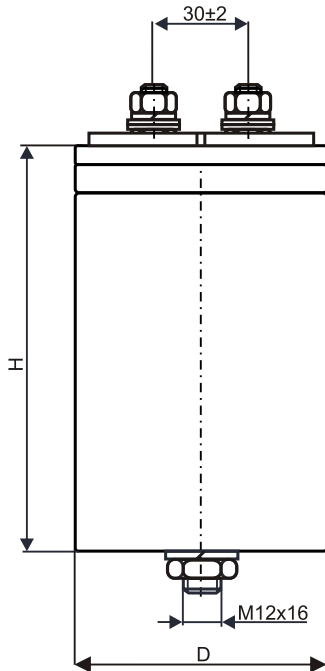

Advantages over Electrolytics:

- Exceptionally low ESR
- High ripple current
- Non-Polar
- High voltage ratings
- Dry construction

Technical data:

Capacitance tolerance:

±10%

Screw terminals:

M8 x 20

Operating temperature:

-55°C ÷ 85°C

Max rms voltage:

250VAC

Case material:

AL./plastic

Impregnant:

Dry resin UL94V-0

Capacitance µF	DC Voltage V	du/dt V/µs	Max RMS current A	ESR mΩ	ESL nH	DxH mm
120	600	12	28	3,2	55	55*x120
150	600	12	32	2,7	58	65x140
200	600	11	40	2,2	60	80x140
250	600	11	50	2,2	60	80x140
500	600	8	50	4,4	78	80x240
150	900	11	30	6,2	58	65x140
200	900	10	25	4,0	60	80x140
300	900	9	30	2,4	60	80x240
500	900	8	40	4,6	78	80x240
100	1300	7,6	20	9,4	65	80x140
200	1300	7,4	28	5,7	65	80x240
33	1800	25	20	7,0	65	80x140
66	1800	21	30	4,8	75	80x240
20	3000	15	15	4,8	70	80x140
40	3000	10	25	4,2	70	80x240

*Diameter 55 mm available to with plastic can

MITRA

Ltd
99-300 Kutno; 1 Grunwaldzka St.
Poland
tel./fax: +48 24 253 60 71
tel. +48 24 355 13 36
<http://www.mitra.com.pl>
e-mail: mitra@mitra.com.pl